

# Friends of Robinson Gardens

2011 Garden Tour

May 13, 2011

FRIENDS

OF

ROBINSON

GARDENS





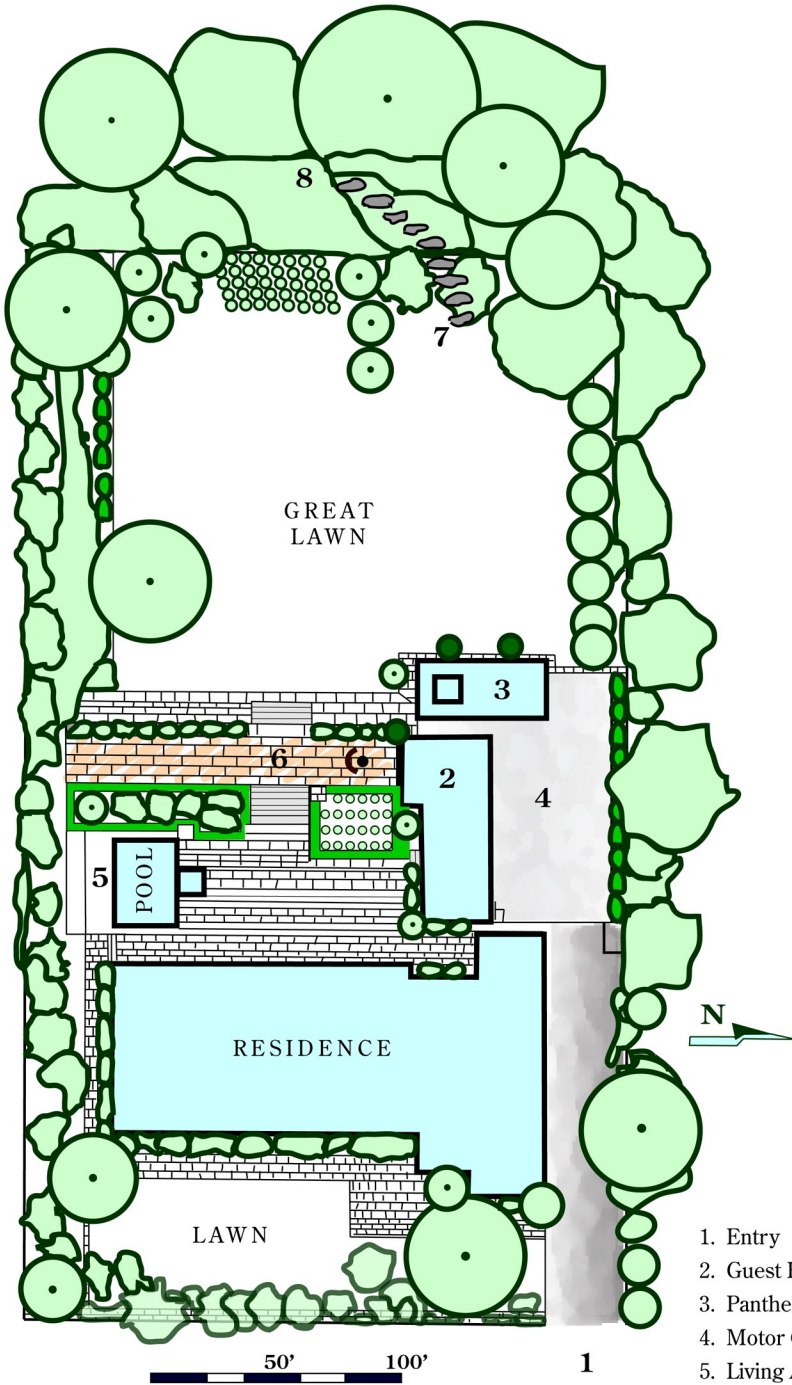

50' 100'

1. Entry
2. Guest House
3. Pantheon
4. Motor Court
5. Living Architecture
6. Terrace
7. Lower Stairway
8. Meditation Garden

*Splendore di Frutta*



# “Splendore di Frutta”

LANDSCAPE DESIGN BY Eric Solberg

ative Sycamores tower over the entrance to this beautiful Tuscan country estate nestled in the foothills of Brentwood. Built in the early 1990's on the foundation of a 1920's two story Monterey style ranch house, the owners wanted to achieve a design that unites the past gardens with more contemporary landscaping elements.

Entering on to a pebble drive, a shaded pathway leads you to the front of the residence and beyond. The front door, a heavy wooden antique castle door once belonging to the William Randolph Hearst collection, communicates strength and power. Unfolding out over the pathway, a lawn formally edged with antique brick pavers gives a monastic feel to the Front Garden. Sculpted trees and shrubs adorn the façade of the residence, softening the structure while suggesting more to come.

Moving along the path towards the rear of the residence, a clipped boxwood hedge and large camellias fill all the space along the way. The walkway steps up to the back of the main house revealing a magnificent private view. Formal vignettes and clusters of trees and greenery compose the vista, which stretches across the great lawn to a mature eucalyptus grove. Sequestered below these majestic eucalyptus trees rests the Meditation Garden. Threaded along the length are a series of outdoor rooms and formally planted beds of roses, hydrangeas, and tightly clipped shrubs. One of the outdoor rooms is the original plant propagation shed which has been transformed into a small gallery. There is also a “Pantheon” of garden gods complete with oculus. Terraces for outdoor dining and entertaining surround a classically styled pool joined by whimsical living architecture creating a dramatic vertical garden. Ultra modern furnishings are woven together with climbing renaissance roses draping over columns of antiquity.

The entire garden is a dichotomy, a sensation of yin and yang. New upon old, like Romans building on the foundation of the Etruscans, layers of humanity coming together in this lyrical and intensely private place.